



LED BEKA SERIES 50

BEKA SERIES 50



52126 Opaque



51126 Prismatic



APPLICATIONS

- Commercial and housing developments
- Public buildings

KEY ADVANTAGES

- Ingress protection - IP 66
- High-pressure die-cast aluminium base
- High-impact acrylic diffuser
- Range of LED and CFL lamp sources
- Reduced light pollution
- T_a rating of 35°C

CONSTRUCTION DETAILS

The luminaire consists of a high-pressure die-cast aluminium (EN 1706 AC-44300) base and trim ring, and an opaque or clear prismatic high-impact acrylic diffuser. It is designed to operate a range of compact fluorescent lamps and LEDs of 15W.

SABS MARKS

The luminaire bears the SANS 60598-2-1 safety mark.

INGRESS PROTECTION

IP 66 in compliance with SANS 60598-2-1:

The IP rating is certified by a SABS test report.

BASE

- All base castings are manufactured from high-pressure die-cast aluminium, finished both outside and inside in white epoxy powder coating for added protection and reflectivity.
- It is simple to install due to four mounting holes provided outside the lamp compartment through lugs that form part of the base casting.
- The incorporated reflector is manufactured from 99.98% super pure deep anodized aluminium for optimal downward light output.
- The trim ring casting is mounted onto the base casting by stainless steel M5 Allen head screws, located outside the lamp compartment.

- The fixing holes can be supplied with stainless steel helicoil inserts on request.

DIFFUSER

- An opaque or clear prismatic non-discolouring high-impact acrylic injection moulded diffuser is used throughout the range.
- It offers excellent vandal resistance, is highly translucent and will not discolour even when subjected to the harshest UV environments.
- A silicon sponge gasket is fitted into a special groove in the diffuser to prevent damage to the gasket during installation.
- It fits snugly over a tongue provided on the base casting, thus achieving the certified ingress protection rating of IP 66.

TRIM RING

- The trim ring casting is manufactured from high-pressure die-cast aluminium and is finished in a special multi stage epoxy powder surface coating.

LED

- Minimum 50 000hrs useful lifetime (L80).
- Effective high-power OSRAM LED, 5000K at a colour rendering index >70.

ELECTRICAL COMPONENTS

- The electronic control gear is mounted directly onto the base casting.
- It is suitable for operation with the specified rating of the lamp on a 220-240V ±10% 50Hz single phase system.
- All inter-connecting wiring is Teflon® insulated with protective sleeving to prevent damage by possible abrasion.
- All external screws, bolts and metals are stainless steel or of non-corrosive material.
- Mains connections are by means of a suitable screw terminal block with a wire clamping contact.
- The luminaire is power factor corrected to a minimum of 0.9.
- In the LED version, the diffuser is permanently sealed to the aluminium base and is supplied with a 300mm supply lead.

DIMENSIONS IN MM

All interconnecting wiring is Teflon® insulated.

Base casting manufactured from high-pressure die-cast aluminium, finished both outside and inside in white epoxy powder coating for added protection and reflectivity.

Tongue provided on the base casting to fit into the silicon sponge gasket seated in the diffuser, thus achieving SABS certified IP 66 protection.

Four mounting holes provided outside the lamp compartment, ensuring the integrity of the certified IP rating. The mounting holes are raised 2mm from the base, preventing rainwater from running over the luminaire surface, and are also offset from the main axis in order to prevent accidental damage to conduits during the installation process.

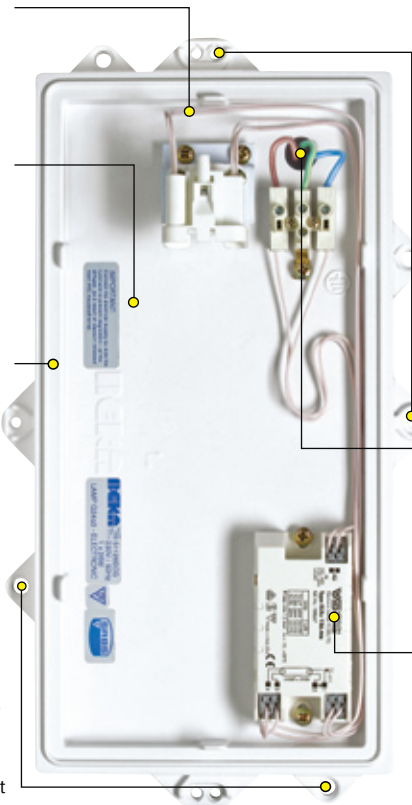

Four fixing holes to hold the trim ring casting to the base casting by stainless steel M5 Allen head screws, located outside the lamp compartment.

The grommet provided in the base casting allows the feeding through of the Teflon® wiring supplied, thus ensuring integrity of IP 66 rating.

All control gear components bear the relevant national and international marks and are mounted directly onto the base casting, ensuring cool operation.

Front view

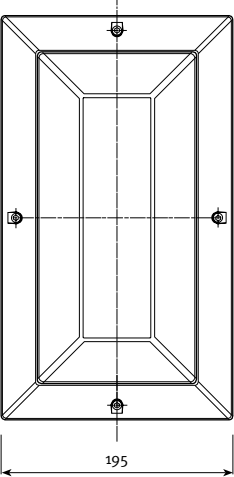

Side view

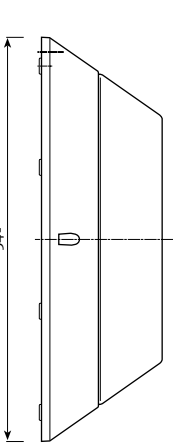

Top view

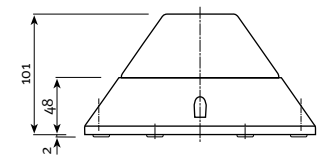

LIGHT DISTRIBUTIONS

INTENSITY DISTRIBUTION

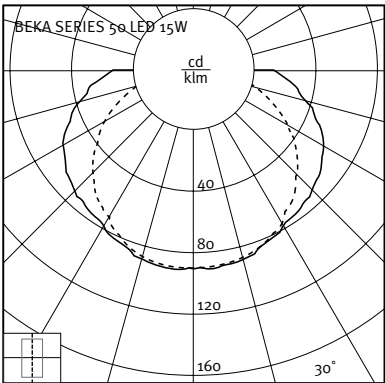

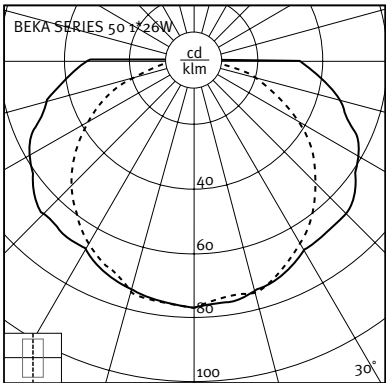
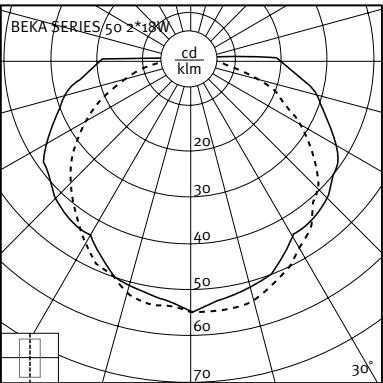

Electronic data files can be downloaded from www.beka-schreder.co.za/knowledge-base

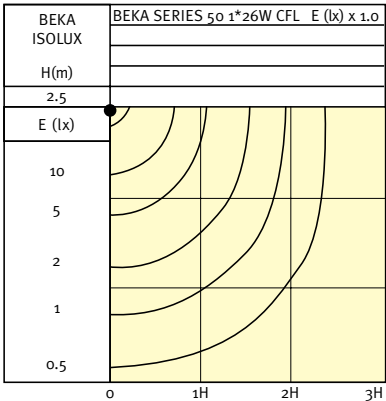
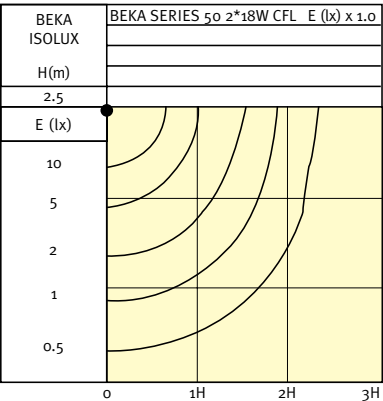
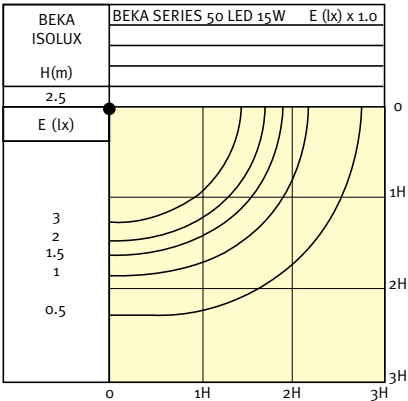

HORIZONTAL ILLUMINANCE



ORDERING DATA

DESCRIPTION	LAMP	LAMP HOLDER	LUMEN	MASS (KG)
LED				
 51012 BULKHEAD LED 15W prismatic-clear	LED 12/1.2W	–	1 656	2.2
 52012 BULKHEAD LED 15W opaque	LED 12/1.2W	–	1 270	2.2
CFL - ECG				
51113 BULKHEAD 13W CFL-ECG prismatic-clear	1*TC-DEL 13W	G24q-1	900	2.5
51118 BULKHEAD 18W CFL-ECG prismatic-clear	1*TC-DEL 18W	G24q-2	1 200	2.5
51126 BULKHEAD 26W CFL-ECG prismatic-clear	1*TC-DEL 26W	G24q-3	1 800	2.5
52113 BULKHEAD 13W CFL-ECG opaque	1*TC-DEL 13W	G24q-1	900	2.5
52118 BULKHEAD 18W CFL-ECG opaque	1*TC-DEL 18W	G24q-2	1 200	2.5
52126 BULKHEAD 26W CFL-ECG opaque	1*TC-DEL 26W	G24q-3	1 800	2.5
EMERGENCY VERSION				
EM-SERIES 51 15W LED 1hr ST	LED	–	214	2.5
EM-SERIES 52 15W LED 1hr ST	LED	–	214	2.5

Standard colour: Black (RAL 9017)

OPTIONS AND ACCESSORIES

ELECTRICAL	
Control gear	Conventional Control Gear (CCG)
MECHANICAL	
Mounting spacer unit	35mm deep surface mount
	50mm deep surface mount
	50mm deep recessed
Extras	Stainless steel helicoil inserts
Colour	White (RAL 9016)
	Silver (RAL 9023)
	Any other colour available on request

Designed and manufactured by BEKA (Pty) Ltd - South Africa
Manufacturers of Luminaires and Glass Fibre Poles

03/14



BEKA (Pty) Ltd | 13 West View Road | P.O. Box 120 | Olifantsfontein | 1665 | South Africa
 T: +27 11 238 0000 | F: +27 11 238 0180
 info@beka-schreder.co.za | www.beka-schreder.co.za

