

ALURA LED



Schröder



LED ALURA LED



3.5 - 5m

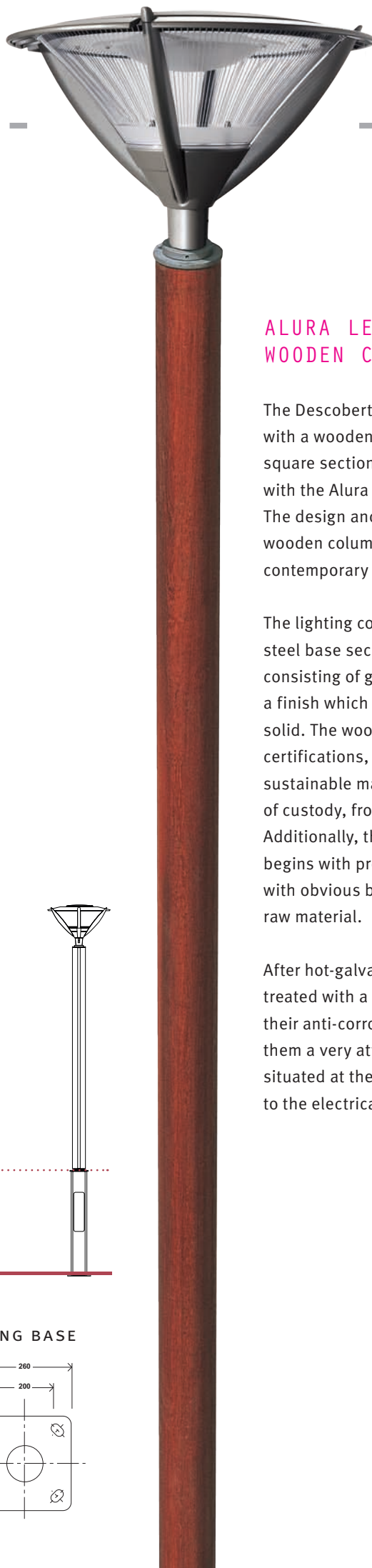

ALURA LED + DESCOBERTAS WOODEN COLUMNS

The Descobertas is a range of lighting columns with a wooden finish. Both the circular and square sections can be used in combination with the Alura LED.

The design and finish of the Descobertas wooden columns makes them ideal for use in contemporary urban environments.

The lighting column has a hot-galvanised steel base section. The wood pool section, consisting of glued sections of Spruce, gives a finish which is both aesthetic and extremely solid. The wood used bears the FSC and PEFC certifications, through which we can ascertain sustainable management throughout the chain of custody, from its origin in forestry onward. Additionally, the construction of the columns begins with profiles made from smaller planks, with obvious benefits for an efficient use of the raw material.

After hot-galvanising, all steel elements are treated with a painting process which optimises their anti-corrosion protection and also gives them a very attractive finish. A small hatch situated at the base of the column gives access to the electrical control gear.

STRAIGHT COLUMNS

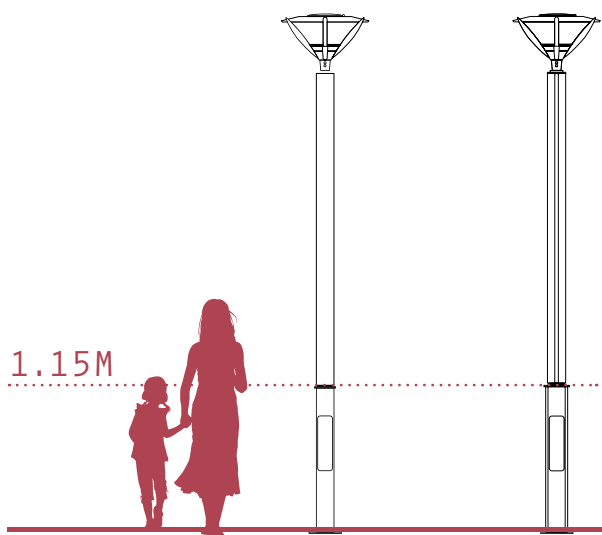

MOUNTING BASE

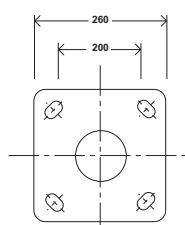

ALURA LED





Design: Michel Tortel



CHARACTERISTICS – LUMINAIRE

Optical compartment tightness level:	IP 66 (*)
Control gear compartment tightness level:	IP 66 (*)
Impact resistance (polycarbonate):	IK 10 (**)
Aerodynamic resistance (CxS):	0.124m ²
Nominal voltage:	230V - 50Hz
Electrical class:	I or II (*)
Weight:	15.5kg

Materials

Base, cover and arms:	Die-cast aluminium
Protector:	Polycarbonate
Colour:	AKZO 900 grey sanded
	Any other RAL or AKZO colour upon request

(*) according to IEC - EN 60598

(**) according to IEC - EN 62262

KEY ADVANTAGES

- Low energy consumption
- Elegant design for low height installation
- Visual comfort
- Robust materials
- Round or square section columns with a wooden finish
- FutureProof: easy replacement of the photometric engine and control gear
- Designed to incorporate Owllet range of control solutions
- Surge protection 10kV

AMBIANCE LIGHTING COMBINED WITH COMFORT AND EFFICIENCY

The Alura LED luminaire combines efficiency, aesthetics and visual comfort. With its timeless elegance and its high performance photometry, this luminaire is a distinctive tool to light urban centres, squares, bike paths, residential streets and car parks.

Available with a structured or smooth polycarbonate protector with internal ribs, the Alura LED creates a warm ambiance while providing huge energy savings thanks to its performing LensoFlex®2 photometric engine. It ensures safety and well-being in the public space in the most sustainable way.

Composed of high-quality recyclable materials, the Alura LED is built to last. Using state-of-the-art technology, it is FutureProof: the optical unit or the control gear can be replaced at any time to take advantage of future technological improvements.

DIMENSIONS - MOUNTING

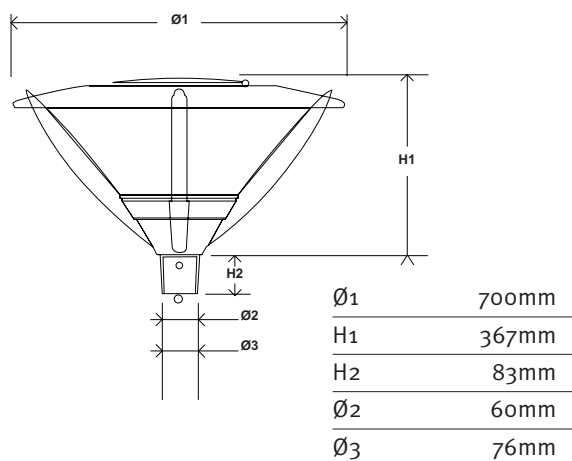

The Alura LED luminaire offers slip-over mounting onto a 60mm diameter spigot by the tightening of 6 M6 or 2 M8 (optional) screws.

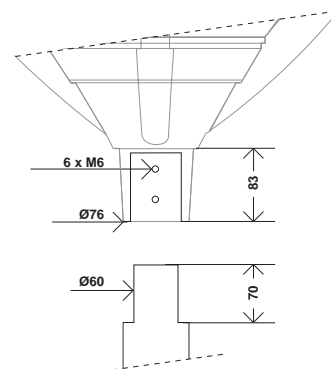

LENSOFLEX®2

The Alura LED luminaire is equipped with second generation LensoFlex®2 photometric engines that have been specifically developed for lighting spaces where the well-being and safety of people using the environments are essential. This system is based upon the addition principle of photometric distribution. Each LED is associated with a specific lens that generates the complete photometric distribution of the luminaire. It is the number of LEDs in combination with the driving current that determines the intensity level of the light distribution.

ENERGY SAVINGS OF UP TO 75%

The Alura LED luminaire integrates the latest cutting edge technologies. The combination of LED technology, a driver working within a constant flux system and a dimming system makes it possible to achieve energy savings that can reach up to 75% compared with luminaires equipped with traditional light sources.

With this very favourable energy balance, Alura LED contributes to the effective management of public finances and to the responsible use of energy.

FUTUREPROOF

The Alura LED luminaire has been designed to be FutureProof. Both the LED unit and the electronic assembly can be replaced to take advantage of any future technological developments.

BACK LIGHT CONTROL: PREVENTING INTRUSIVE LIGHT

As an option, some versions of the Alura LED can be equipped with a Back Light Control system. Thanks to an additional control plate inside the luminaire body, light spill from the back of the luminaire is minimised to avoid intrusive light on buildings.

HIGH-QUALITY RECYCLABLE MATERIALS

The Alura LED luminaire is composed of high quality materials. The base section, arms, top cover and cover plug are made of die-cast aluminium. Two versions of the protector are available: one clear striated and one sanded striated. Both versions are made of UV-resistant polycarbonate.

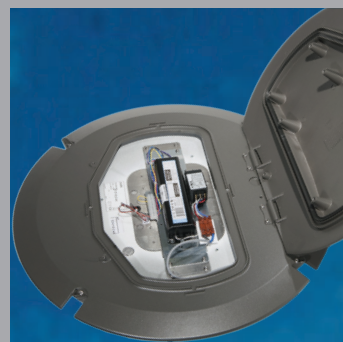

PHOTOMETRY

LENSOFLEX®2						Lifetime residual flux @ t _a 25°C (*)
Number of LEDs	Neutral white (4000K)	16 LEDs	24 LEDs	32 LEDs	48 LEDs	@100.000h
Current: 350mA	Nominal flux (lm)*	2400	3600	4800	7200	90%
	Power consumption (W)	19	28	36	53	
Current: 500mA	Nominal flux (lm)*	3100	4700	6300	-	
	Power consumption (W)	27	40	51	-	
Current: 700mA	Nominal flux (lm)*	4000	6100	-	-	80%
	Power consumption (W)	38	56	-	-	

(*) The nominal flux is an indicative LED flux @ t_a 25°C based on LED manufacturer's data. The real flux output of the luminaire depends on environmental conditions (e.g. temperature and pollution) and the optical efficiency of luminaire.

Nominal flux depends on the type of LED in use and likely to change in accordance with the continuous and rapid developments in LED technology.

To follow the progress of the luminous efficiency of the LEDs used, please visit our website.

(**) In accordance with IES LM-80 - TM-21.

LIGHT DISTRIBUTIONS



Optic 5096 - street: a light distribution perfectly suited to lighting residential areas, streets and alleys.

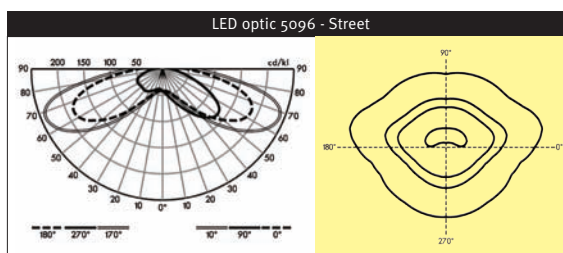

Optic 5096 - square: this light distribution is designed for lighting squares, parks, car parks, public spaces, etc. Only available for 32 LED version.

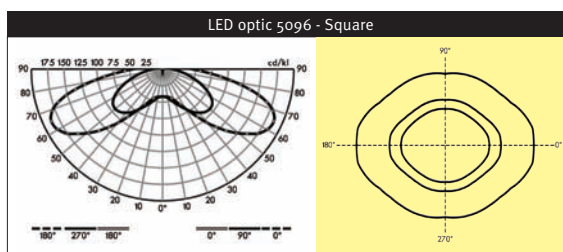

Optic 5098 - road: photometric distribution designed for lighting narrow streets, footpaths, cycle paths ...

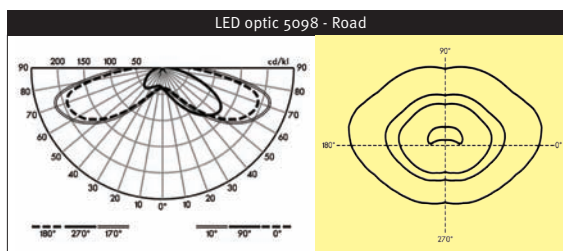

SMART LIGHTING

The Alura LED can integrate the Owlet range of control solutions to operate either in stand-alone mode, in an autonomous network or an interoperable network. Our range of solutions encompasses small areas to complete city networks in order to perfectly suit your requests and your targets in terms of savings.



Thanks to dimming features, light-on-demand options and bi-directional communication, the Owlet solutions allow you to save energy, to provide light only when and where it is required and to optimise the operational management of your lighting scheme in terms of costs and services. The integrated Owlet solutions are key to monitor, to control, to meter and to manage a lighting network in the most efficient way.

PHOTOCELL (STAND-ALONE)

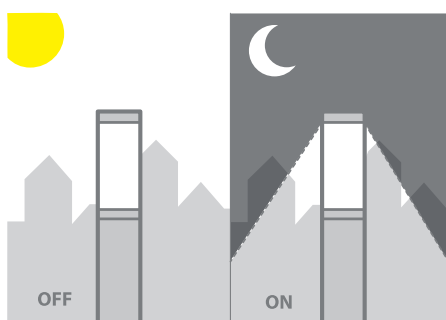

REMOTE MANAGEMENT SYSTEM (INTEROPERABLE NETWORK)

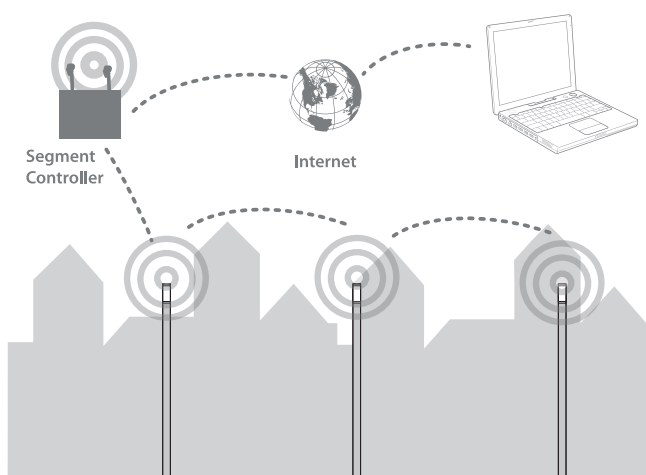

MOTION DETECTION (AUTONOMOUS NETWORK)

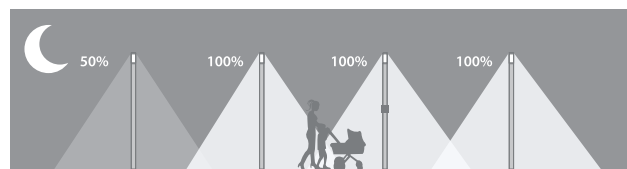
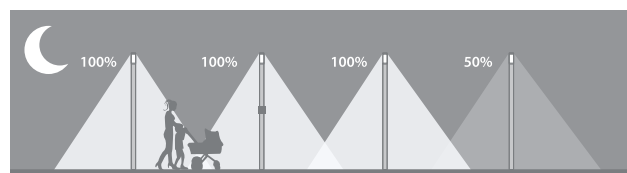
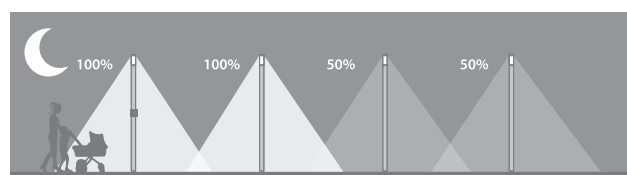
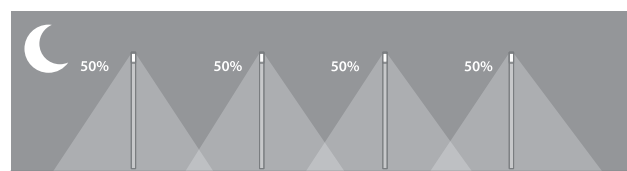



Copyright © Schréder S.A. 2014 - Executive Publisher: Marie-Gabrielle Kokken - L.a.W. S.A. - rue de Mons 3 - B-4000 Liège (Belgium) - The information, descriptions and illustrations herein are of only an indicative nature. Due to advanced developments, we may be required to alter the characteristics of our products without notice. As these may present different characteristics according to the requirements of individual countries, we invite you to consult us.

